

EMU/M-0-3-004



③ 5/76

THE ASSY. DRG. NO.  
DC/EMU/M-0-3-001 DELETED.  
CDA: -Sd.-

② 1/72

DIM ALTD. FROM 80x16x1468  
TO 16x80x1468 FOR ITEM-1.  
CDA: -Sd.-

SURFACE  
ROUGHNESS  
VALUE TO  
IS:3073

GRADE NUMBER

Ra  $\mu$  m

SYMBOL

N1

N2

N3

N4

N5

N6

N7

N8

N9

N10

N11

N12

▽ ROUGH MACHINED

▽▽ FINISH MACHINED

▽▽▽ FINE FINISH MACHINED

① ROUGH CLEANED

⑬ CHAMFERED

⑯ BURRS REMOVED

ALTERATIONS

g 11/2006  
QTY. FOR COL.I ALTD. FROM  
'PER COACH' TO 'PER ASSY'.  
AND NO. OF ASSY REQUIRED  
PER COACH ADDED.  
Sd.-20-11-2006  
SSE/D AME/D

h 10/2011  
NOTE-4 & 5, DIM. 28 AND  
VIEW AT-Z ADDED. MAT. SPEC.  
FOR ITEMS-1 TO 3 AND NOTE-2  
UPDATED. WELDING ANNOTATION  
REVISED AS PER IS:813.  
SUBMERGED ARC WELDING (12)  
SPECIFIED AS PER RDSO STR-  
C-9202.  
SSE/D AME/D



16  
06  
12

LATEST ICF. DRG ALT'N 'h' &  
STOCK No. UPDATED.  
ECN No.90600567

MVR  
IP

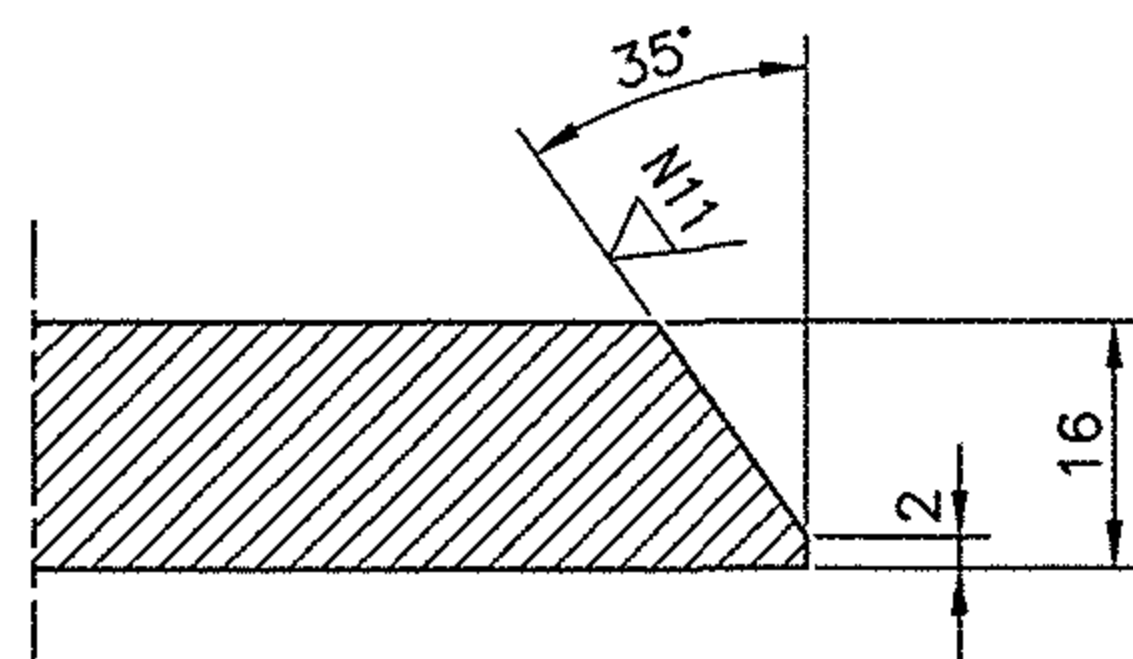
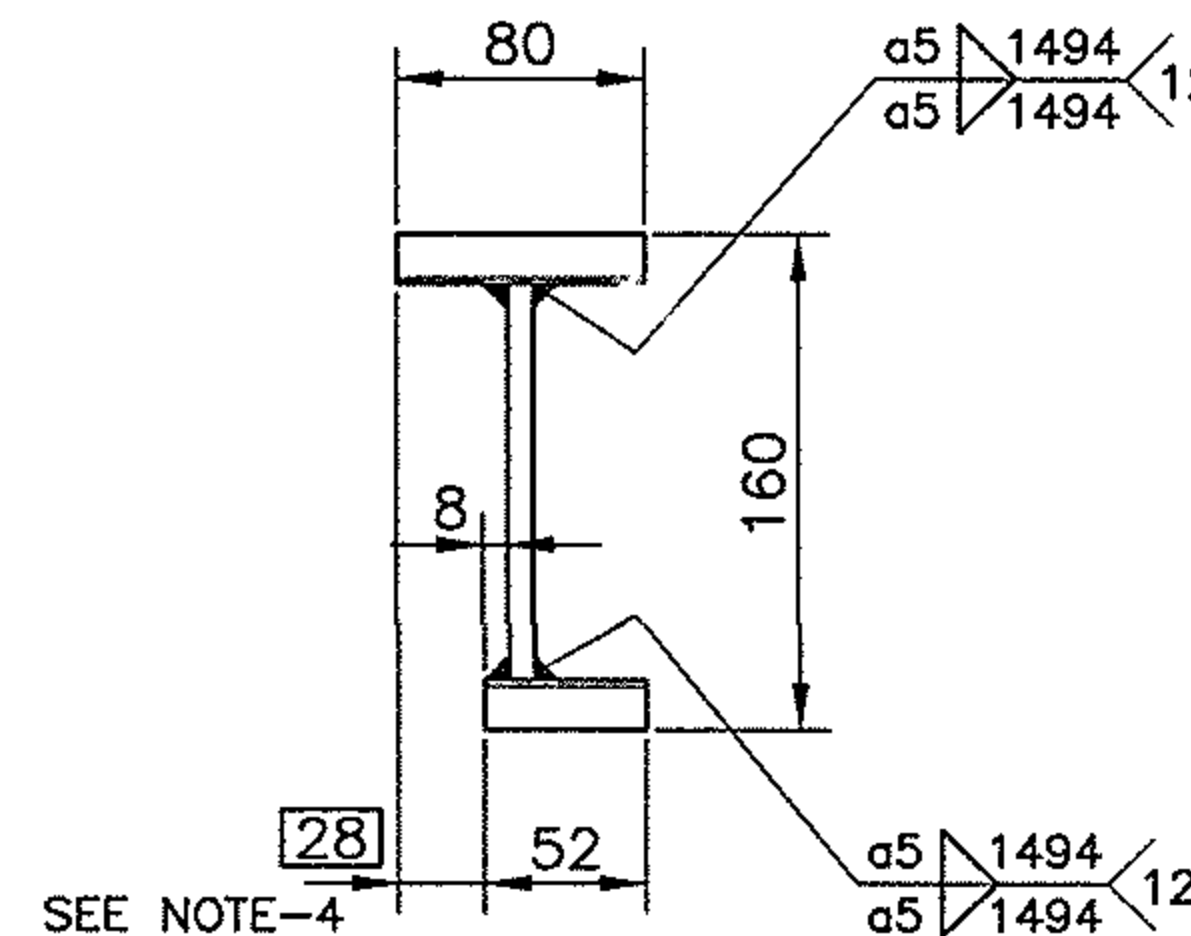
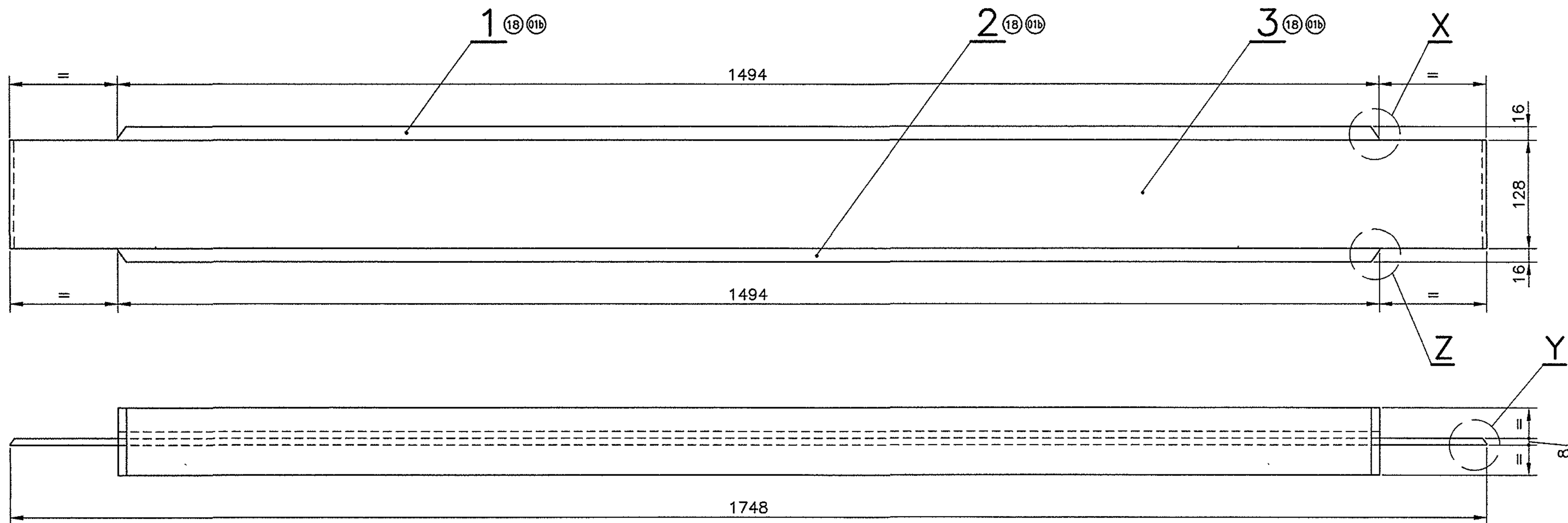

VIEW AT-X

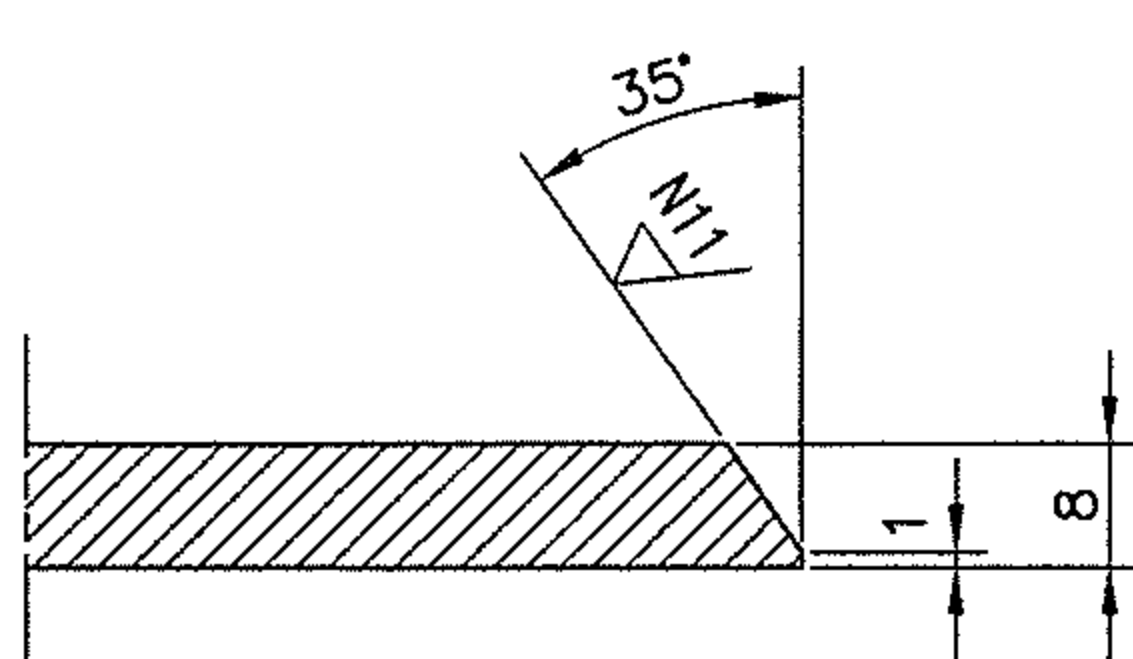

VIEW AT-Y

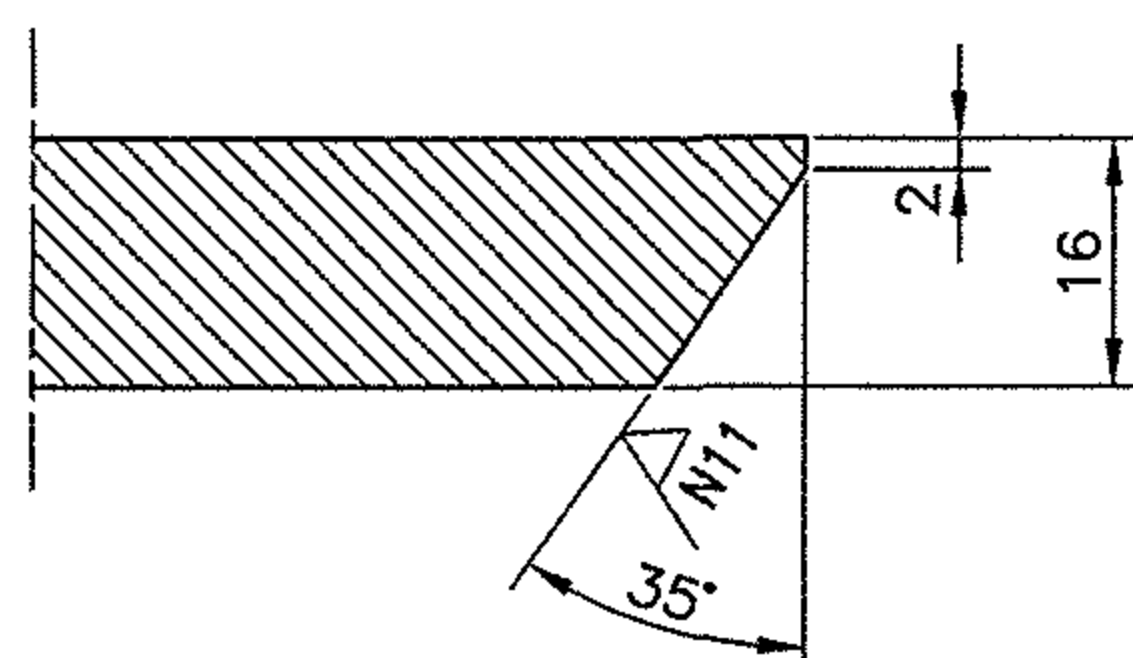

VIEW AT-Z

NO.OF ASSY REQD. PER COACH		
TYPE OF COACHES	COLS.	I
⊕ EMU/M, DC/EMU/M, DMU/DPC, MEMU/DMC, DMU/DPC5 AC/DCEMU/M2, AC/DCEMU/C2, AC/DCEMU/D2		4



NOTE:

- SHRINKAGE ALLOWANCE FOR WELDING TO BE GIVEN FOR ITEMS 1,2 & 3 WHILE CUTTING.
- THE FINISHED ASSEMBLY SHALL BE THOROUGHLY CLEANED AND APPLIED WITH TWO COATS OF RED OXIDE ZINC CHROMATE PRIMER TO IS:2074 TO A DFT OF MINIMUM 35 MICRONS WITH SMOOTH & MATT FINISH. MACHINED SURFACES SHALL BE APPLIED WITH RUST PREVENTION OIL.
- FOR UNTOLERANCED DIMENSIONS, REFER DRG. No. ICF/STD-9-0-001.
- DIMENSIONS MARKED   THUS SHALL BE STRICTLY ADHERED TO.
- ALTERNATIVELY MATERIAL TO IS:2062 E 250 C MAY BE USED FOR ITEMS-1&2.

SV/DPC-0-3-001				1	WEB	8x128x1748	3	R103001008	IS:2062 E 250 Cu C	14.017 kg						
ICF/MRVC/D-0-3-001				1	BOTTOM FLANGE	16x52x1494	2	R103001016	IS:2062 E 250 Cu C	9.702 kg	SEE NOTE-5					
ICF/MRVC/M-0-3-001				1	TOP FLANGE	16x80x1494	1	R103001016	IS:2062 E 250 Cu C	14.926 kg	SEE NOTE-5					
AC EMU/M/ASR-0-3-004	No. OFF				DESCRIPTION & DIMENSIONS			ITEM	REF.DRG	MATL. & SPEC.	WEIGHT/UNIT	REMARKS				
DMU/DPC10-0-3-013	IV	III	II	I	GROUP: BOGIE FRAME ARRGT. [0-3]						SUPERSEDED BY:					
AC/DCEMU/M2-0-3-201				PER ASSY	<div>HEAD STOCK COMPLETE</div> <div>FOR BOGIE FRAME</div>						SUPERSEDES: EMU/M-0-3-004 ALT-g/3					
DMU/DPC5-0-3-501											SCALE	SSE/D	M. Subapathyrar			
DMU/DPC-0-3-009											1:1	CHD				
DMU/DPC-0-3-001											1:5	ALT	Dr. Muralidhar			
EMU/M-0-3-093												DRN	J. Ramesh			
ASSEMBLY DRAWINGS					CAD FILE: C:\MD-CAD\089\0-3\004-SH03.DWG						ALT	h				
												INTEGRAL COACH FACTORY CHENNAI - 38				M5